

View from rear

All parts of wheelbox 1/4" exterior plywood with 1x1 (nominal) framing.

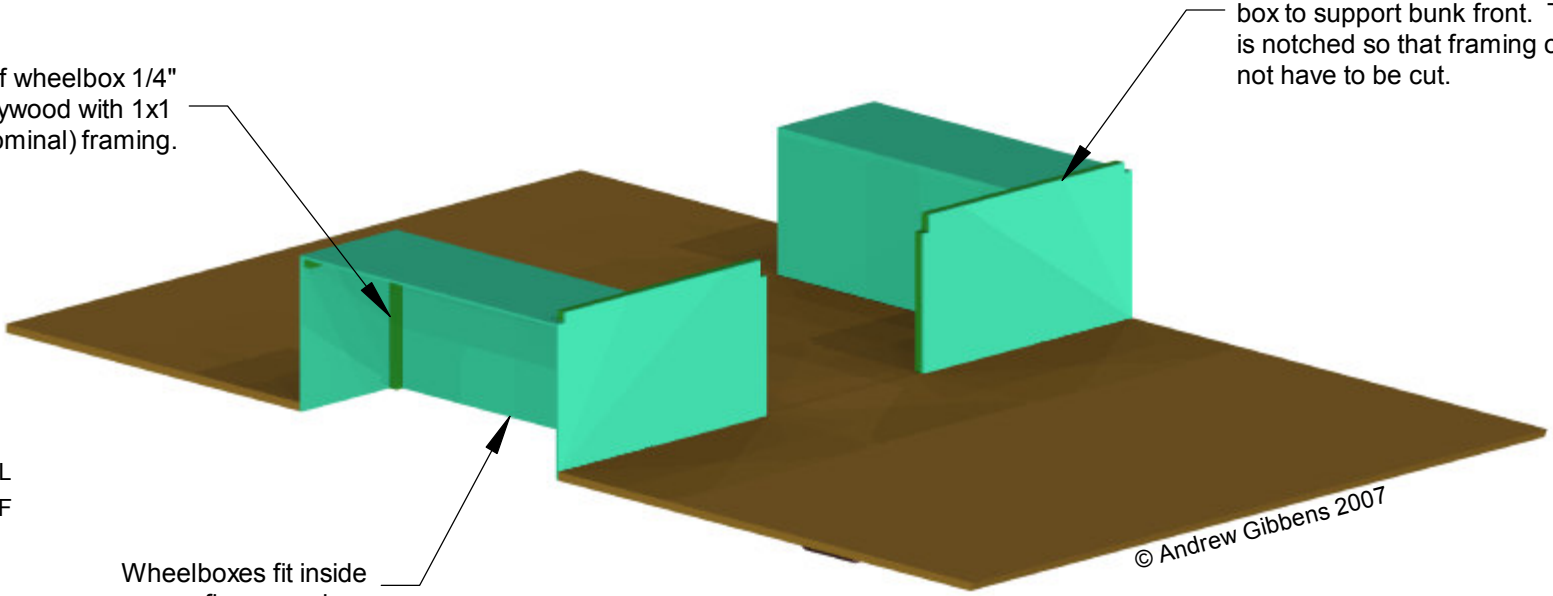

Wheelboxes fit inside floor openings

Front of wheelbox extends above top of box to support bunk top and extends inward from box to support bunk front. Top inside corner is notched so that framing on bunk front does not have to be cut.

View from front
(Body except floor omitted for clarity)

© Andrew Gibbens 2007

1/4" ply bunk fronts and ends

1x2 bunk top supports glued/screwed into framing incorporated in side and front walls

Partial bunk end (rest is closed off by end panel of locker)

© Andrew Gibbens 2007

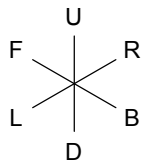

View from rear
(Body except floor omitted for clarity)

INTERNALS 2
Bunk Fronts

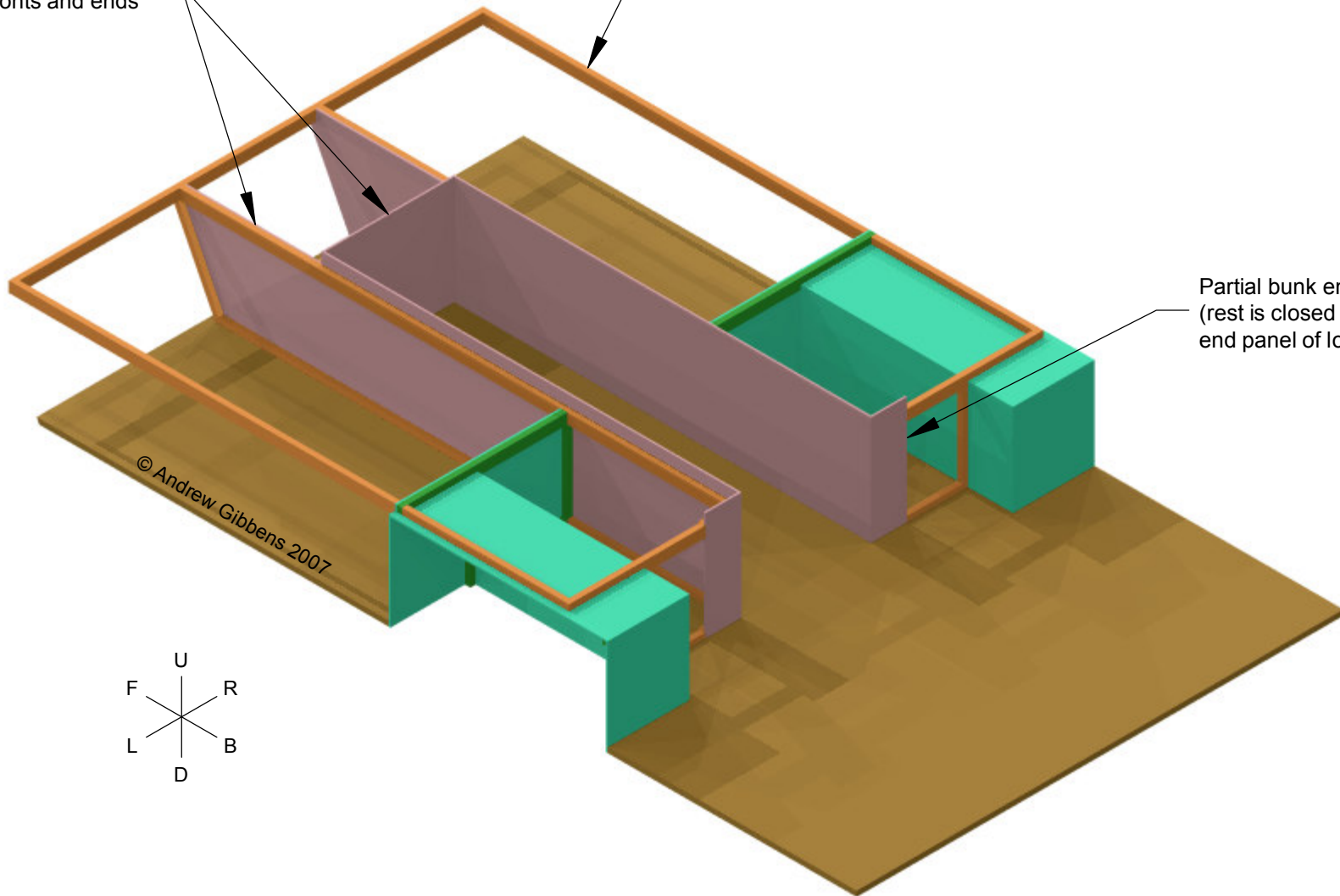

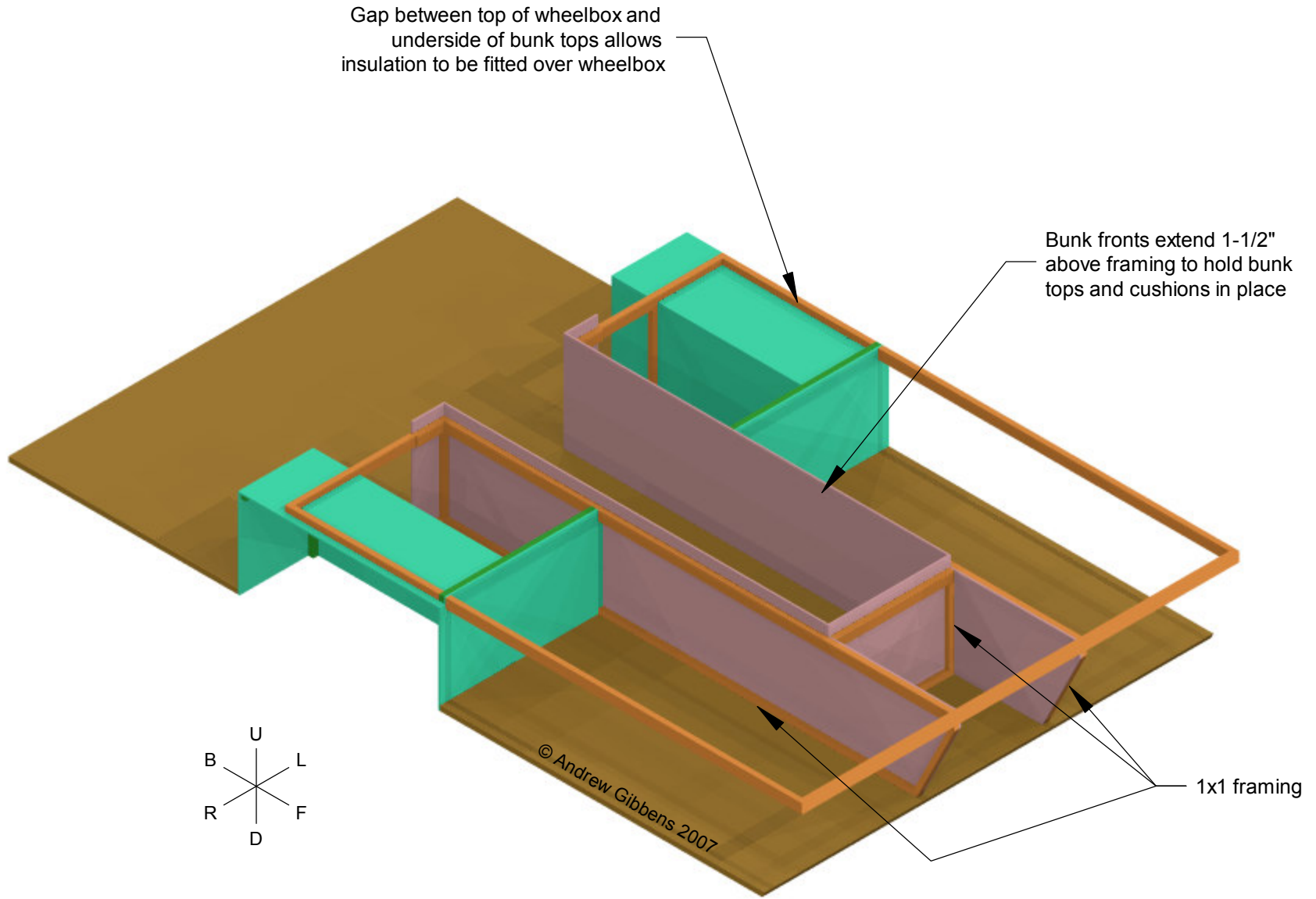

View from front
(Body except floor omitted for clarity)

INTERNALS 3
Bunk Fronts

3/8" plywood bunk tops
in five pieces with 1-1/2"
diameter finger holes

1x2 supports if childrens' bunk is fitted

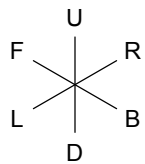
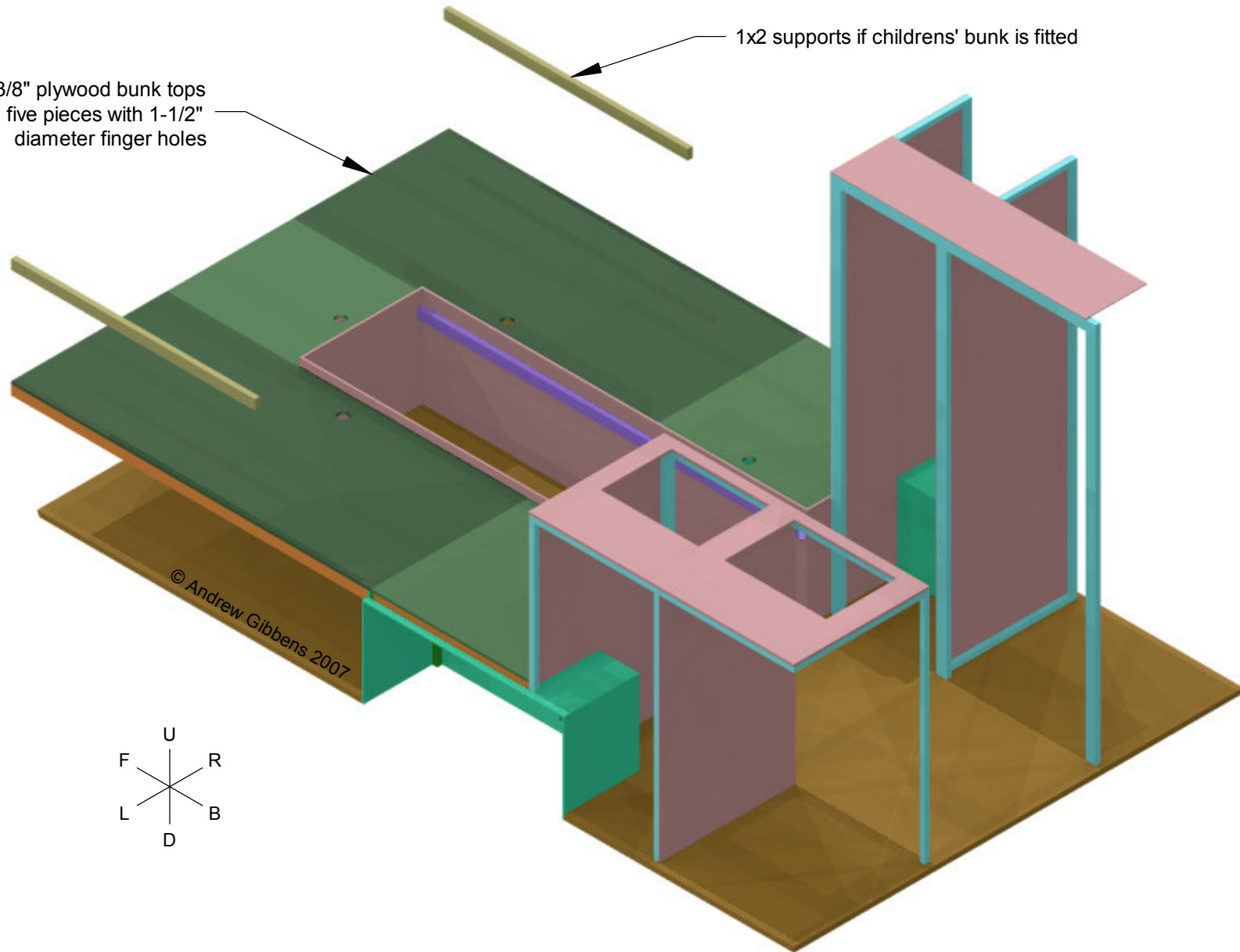

View from rear
(Body except floor omitted for clarity)

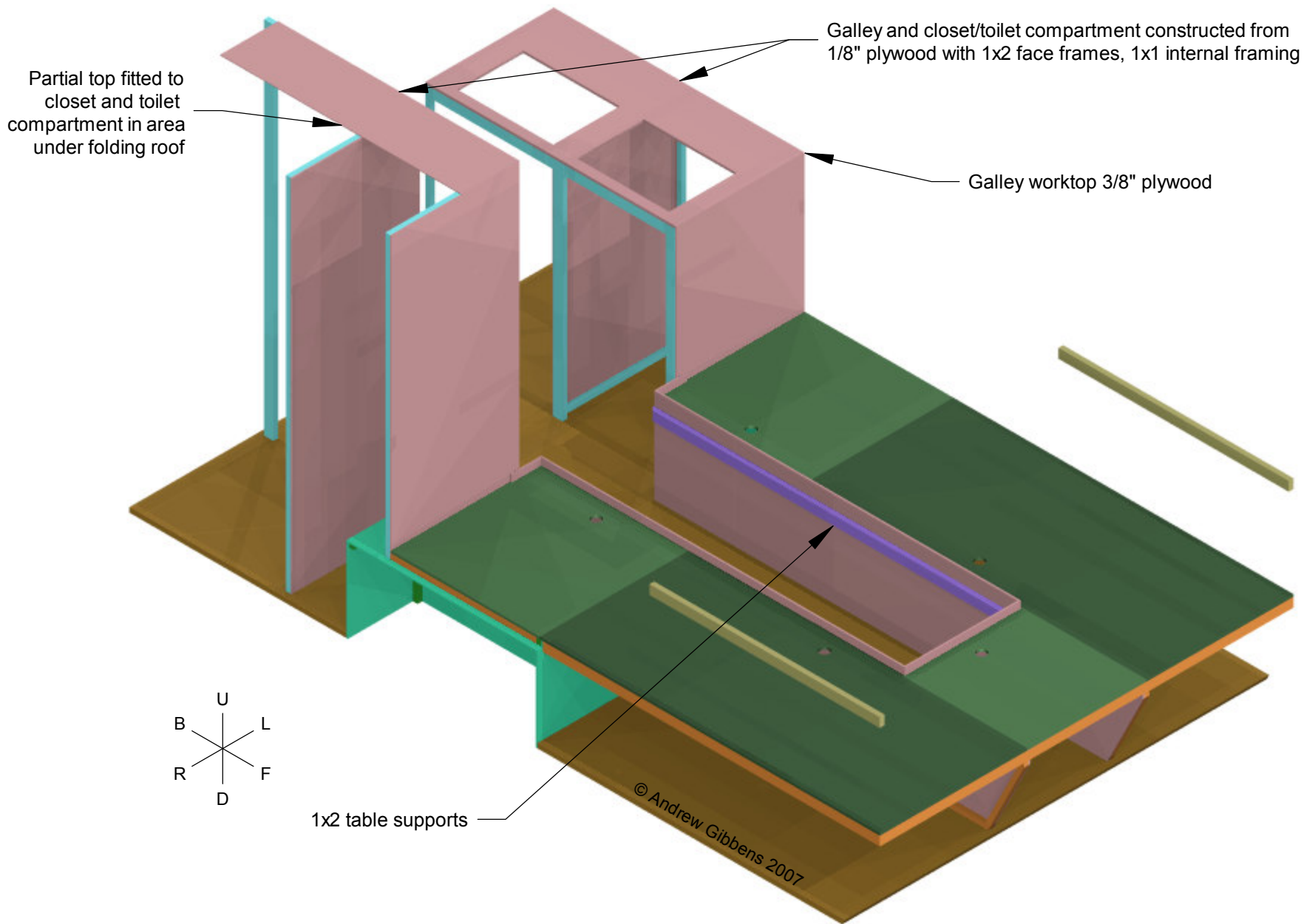

View from front
(Body except floor omitted for clarity)

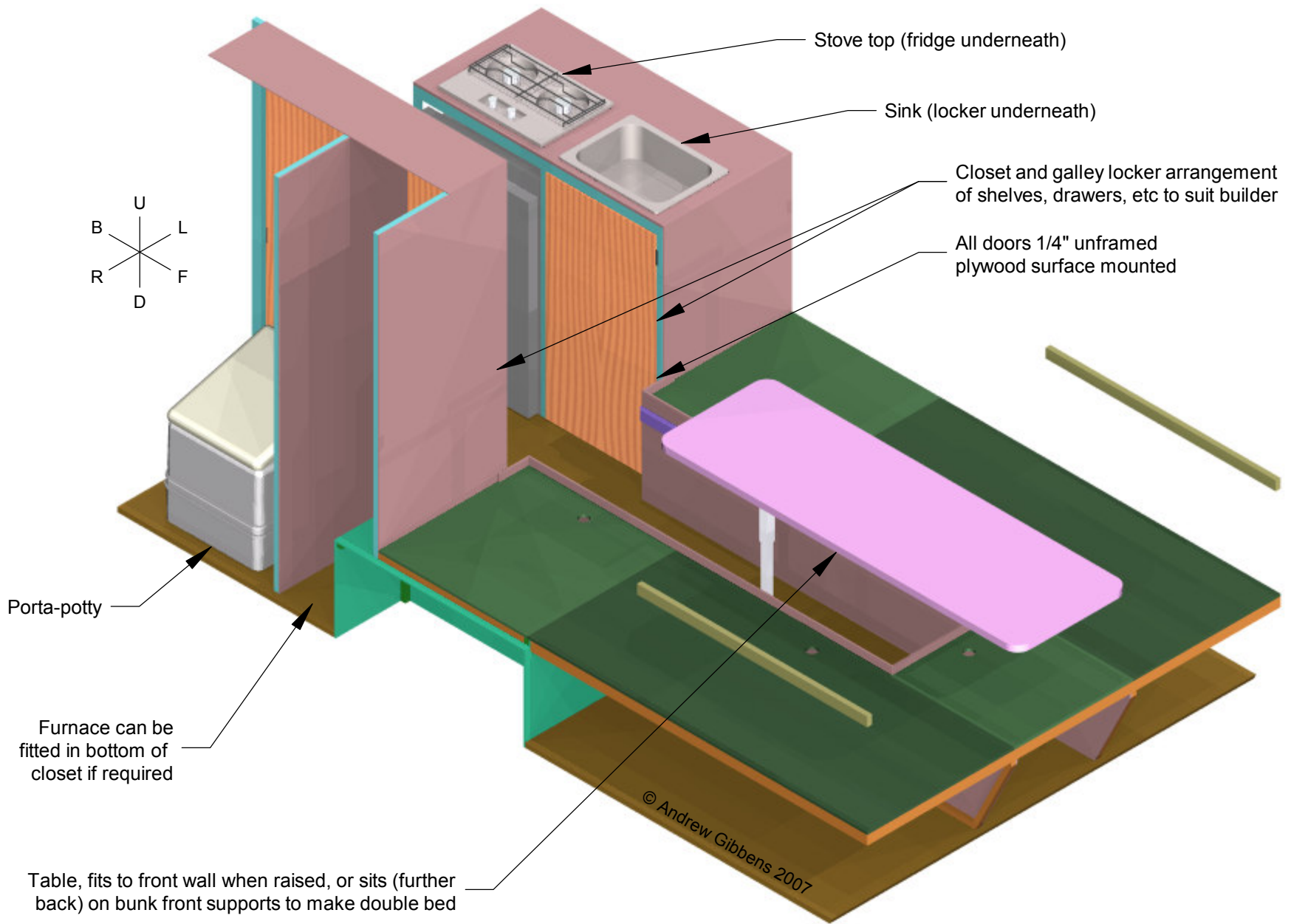

View from front
(Body except floor omitted for clarity)

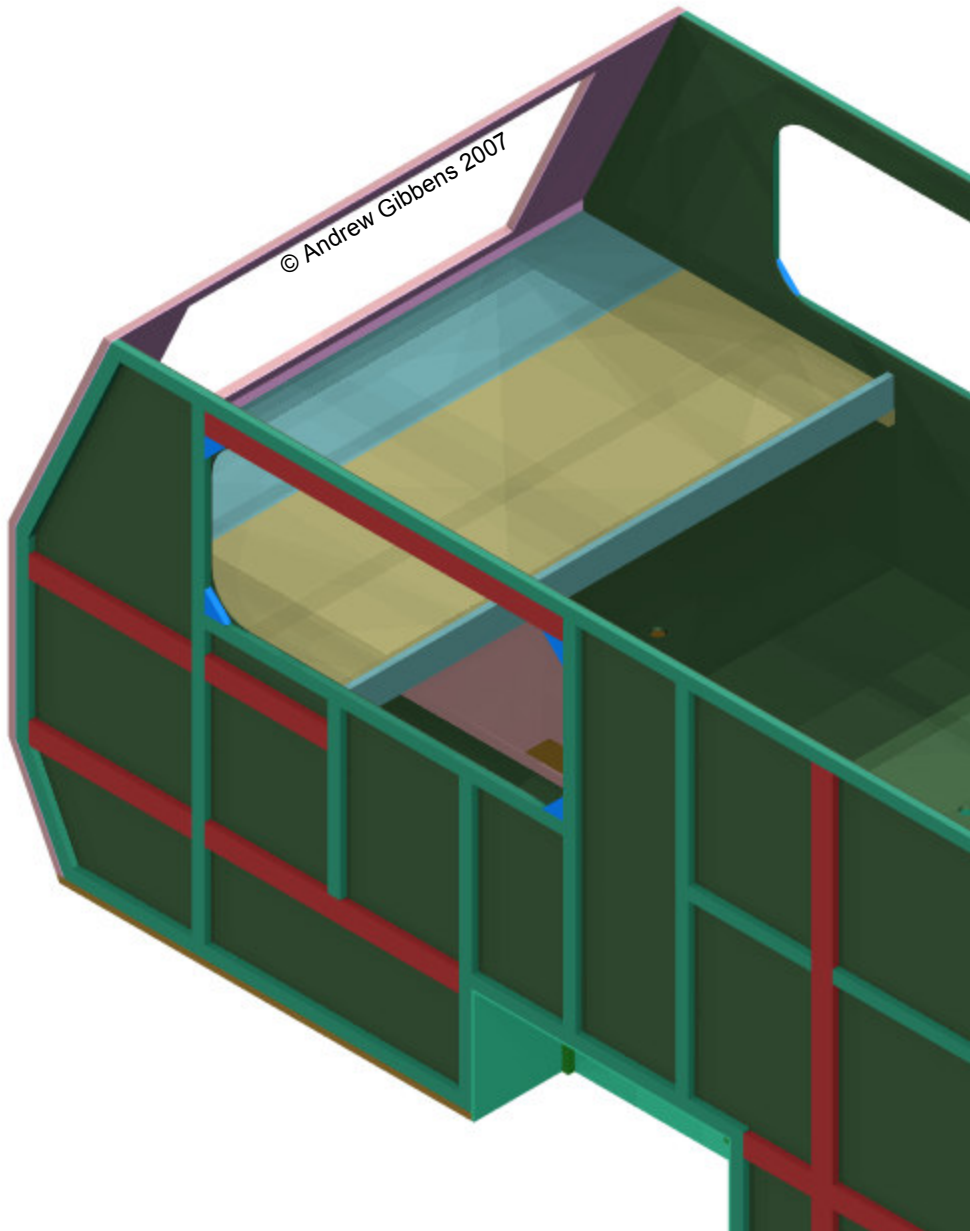

Bunk folded down

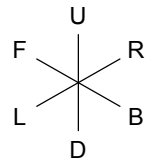

Bunk folded up
(bedding storage behind)

NOTE: Depending on the depth of the window frames, it may be necessary to increase the width of the bunk supports and reduce the width of the folding section of the bunk, to avoid the bunk hitting the window frame as it is folded up.

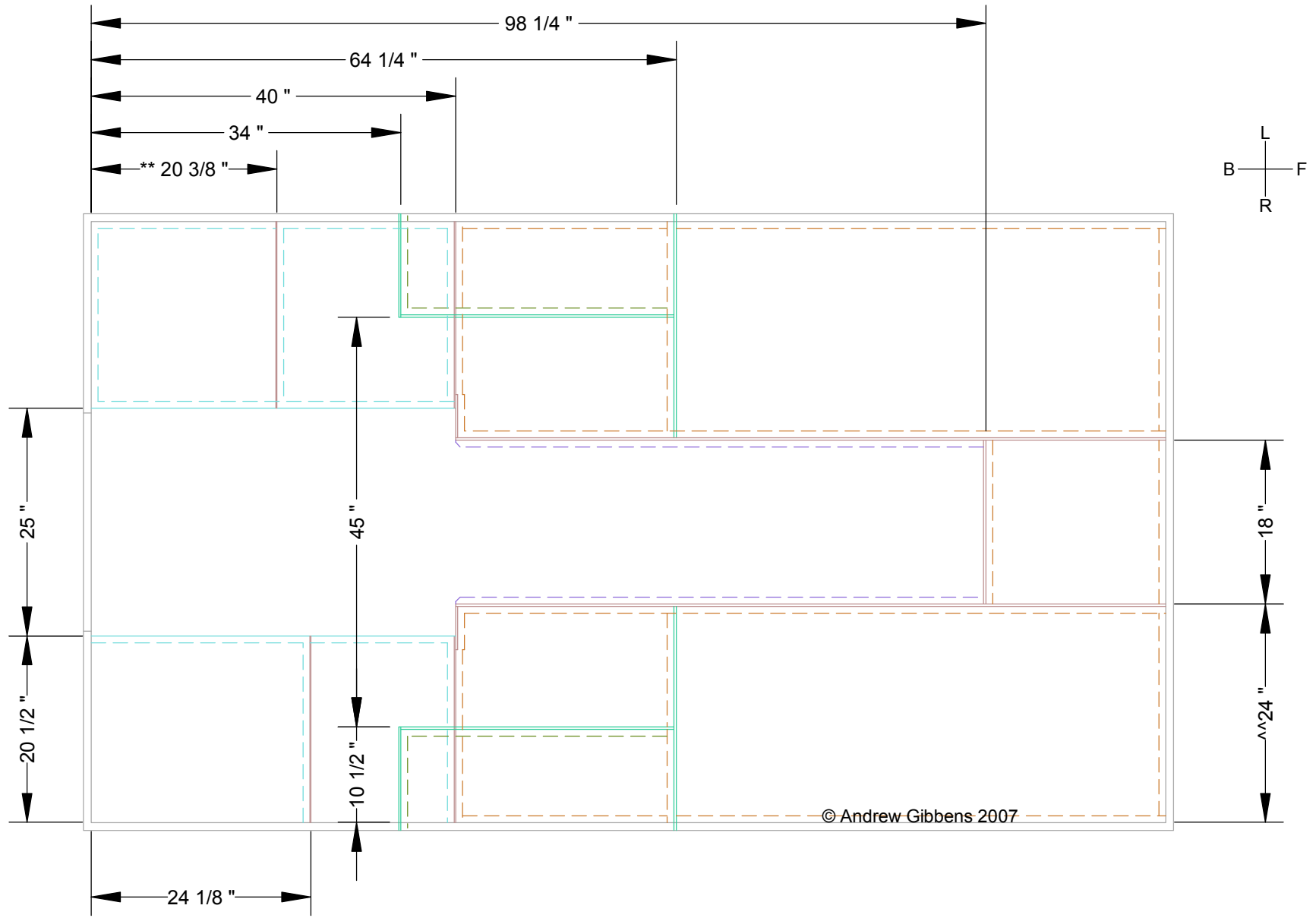

© Andrew Gibbens 2007

Plan View (Plywood in solid lines, framing in dotted lines)

** Dimension to suit Dometic RM 7360 fridge

^^Bunks should be reduced to 22" wide if they are always to be used as double bed and not as singles

INTERNALS 8
1:16

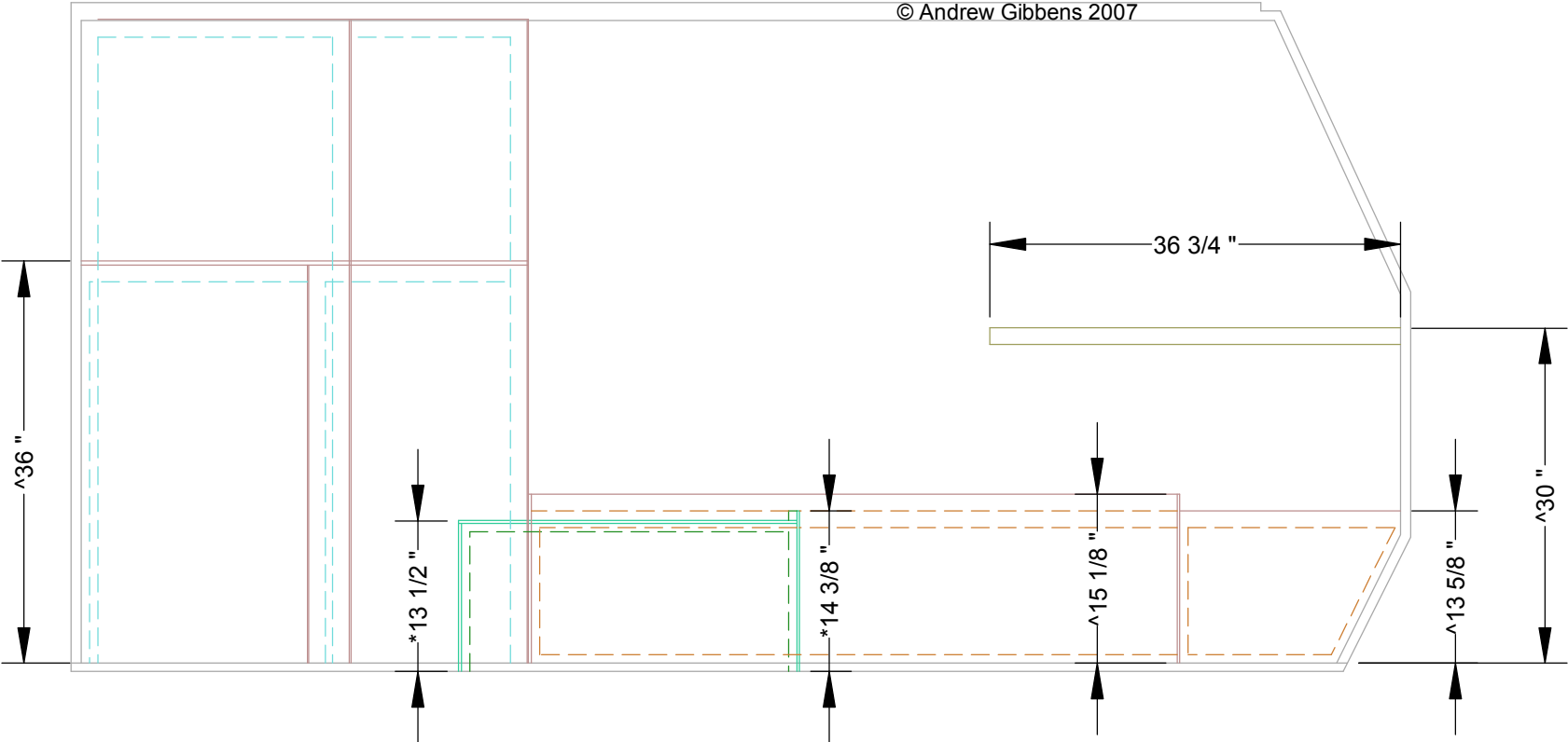

Side View (Plywood in solid lines, framing in dotted lines)
Heights marked '*' measured from underside of floor
Heights marked '^' measured from top of floor